

OLYMPUS

Quick Start Guide

FE-230/X-790 FE-240/X-795

Start Here

For more information, please refer to the Basic & Advanced Manuals or visit: www.olympusamerica.com/support

OLYMPUS IMAGING AMERICA INC.

© 2007 OLYMPUS IMAGING CORP.
Printed in Japan

1AG6P1P3339--

VK557201

1 Gather these items (box contents)

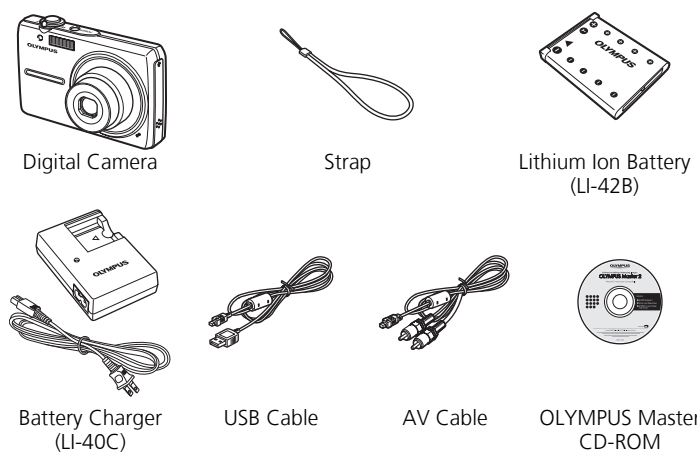

Items not shown: Advanced Manual (CD-ROM), Basic Manual, and the Warranty Card. Contents may vary depending on purchase location.

Attach the strap

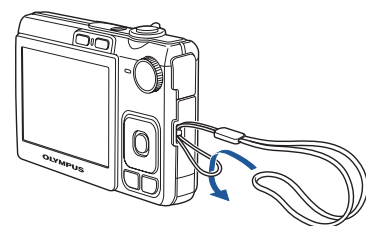

- Pull the strap tight so that it does not come loose.

2 Prepare the battery

a. Charge the battery.

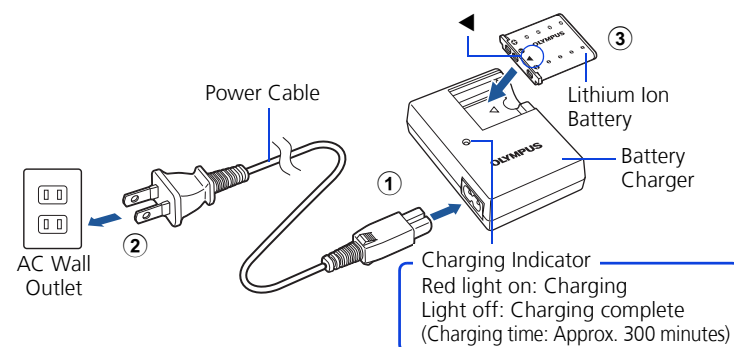

b. Insert the battery into the camera.

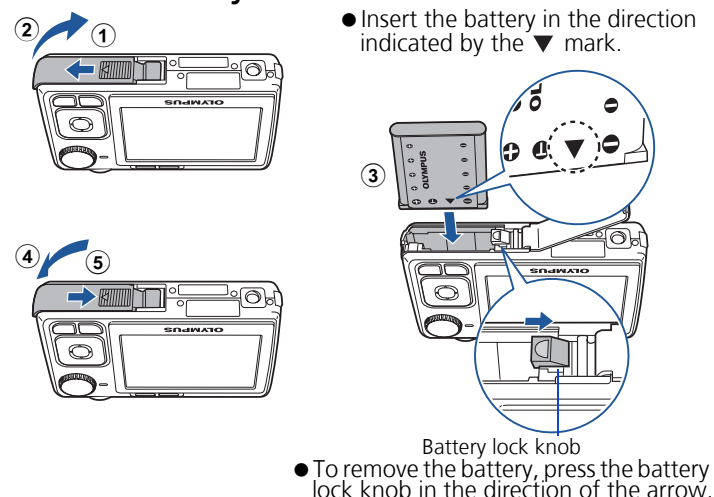

- Battery comes partially charged.
- Insert the battery in the direction indicated by the ▼ mark.
- To remove the battery, press the battery lock knob in the direction of the arrow.

3 Turn the camera on

This explains how to turn on the camera in shooting mode.

a. Set the mode dial to **AUTO**.

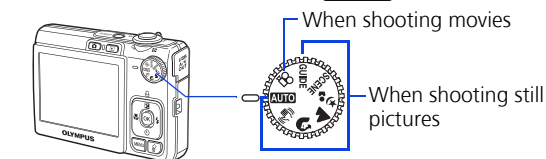

Still picture shooting modes

AUTO	For normal shooting.
	This function reduces the blur incurred by a moving subject, or camera shake when taking pictures.
	Suitable for taking pictures of people.
	Suitable for taking pictures of a landscape.
	Suitable for taking pictures of people at night.
SCENE	Select from 10 available scene modes (FE-240/X-795) or 13 available scene modes (FE-230/X-790), according to the shooting conditions.
GUIDE	Use the shooting guide displayed on the screen to shoot pictures according to the situation.

b. Press the **POWER** button.

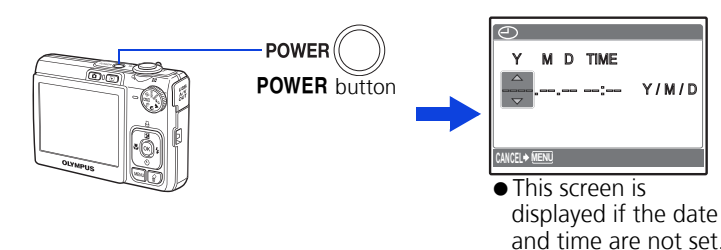

- This screen is displayed if the date and time are not set.
- To turn off the camera, press the **POWER** button once again.

Hint

The directions of the arrow pad is indicated with $\Delta \nabla \leftarrow \rightarrow$ in the supplied instruction manual.

4 Set the date and time

About the date and time setting screen

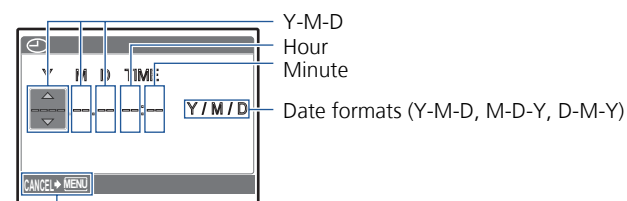

a. Press the Δ / \square and ∇ / \odot buttons to select [Y].

- The first two digits of the year are fixed.

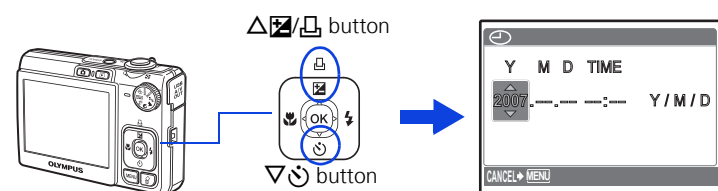

b. Press the \triangleright / \blacklightning button.

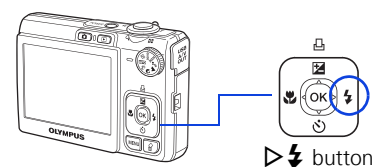

c. Press the Δ / \square and ∇ / \odot buttons to select [M].

d. Press the \triangleright / \blacklightning button.

e. Press the Δ / \square and ∇ / \odot buttons to select [D].

f. Press the \triangleright / \blacklightning button.

g. Press the Δ / \square and ∇ / \odot buttons to select the hours and minutes.

- The time is displayed in the 24-hour format.

h. Press the \triangleright / \blacklightning button.

i. Press the Δ / \square and ∇ / \odot buttons to select [Y/M/D].

j. After all settings have been set, press \odot .

- For a more accurate setting, press \odot when the time signal hits 00 seconds.

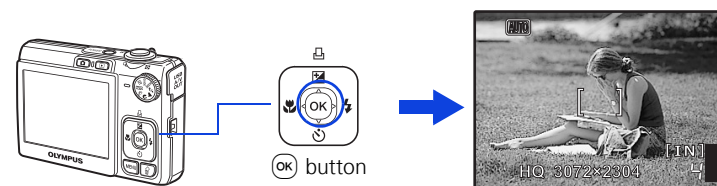

5 Take a picture

a. Hold the camera.



b. Focus.

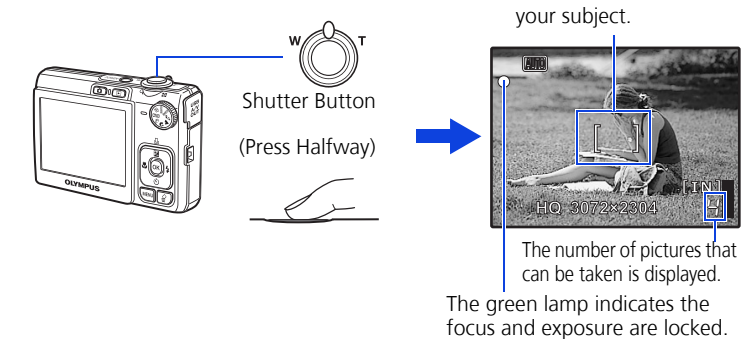

c. Shoot.

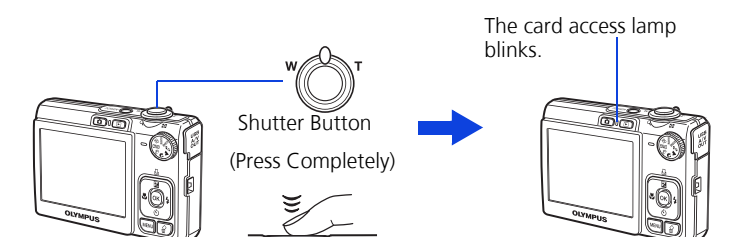

6 Review your pictures

a. Press the \blacktriangleright button.

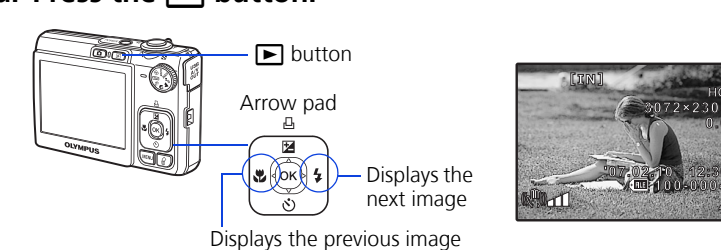

Erase pictures

a. Press the \leftarrow / \blacklightning and \triangleright / \blacklightning buttons to display the picture you want to erase.

b. Press the trash button.

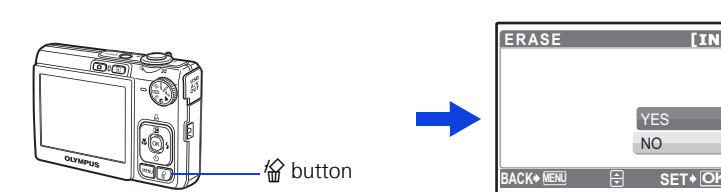

c. Press the Δ / \square button, select [YES], and press \odot .

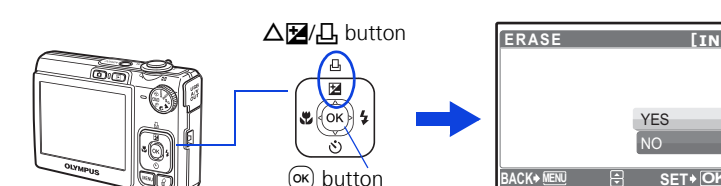

OLYMPUS

Guia de iniciação rápida FE-230/X-790 FE-240/X-795

Começar aqui

Para maiores informações, consulte os Manuais Básico e Avançado ou visite a página web www.olympusamerica.com/support

OLYMPUS IMAGING AMERICA INC.

1 Reunir estes itens (conteúdo da embalagem)

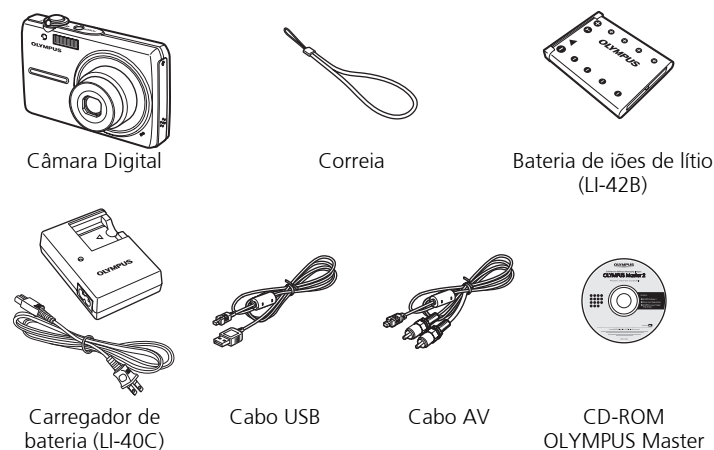

Itens não visualizados: Manual Avançado (CD-ROM), Manual Básico e o Certificado de Garantia. O conteúdo pode variar mediante o local de aquisição.

Colocar a correia

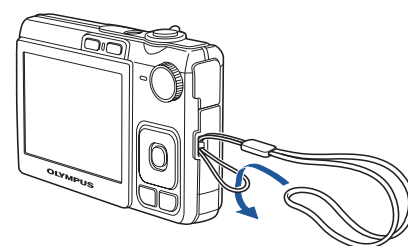

• Puxar bem a correia de modo a que não fique solta.

2 Preparar a bateria

a. Carregar a bateria.

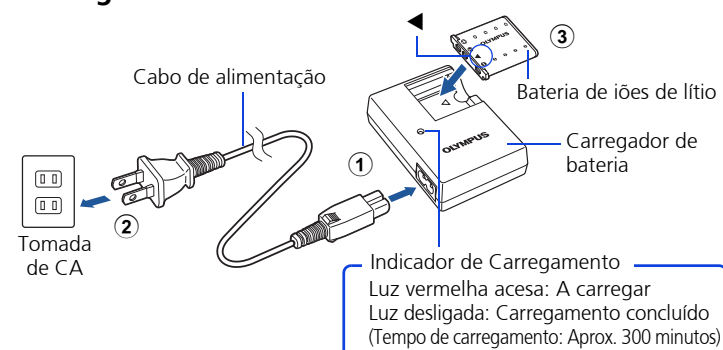

Indicador de Carregamento
Luz vermelha acesa: A carregar
Luz desligada: Carregamento concluído
(Tempo de carregamento: Aprox. 300 minutos)

• A bateria vem parcialmente carregada.

b. Introduzir a bateria na câmara.

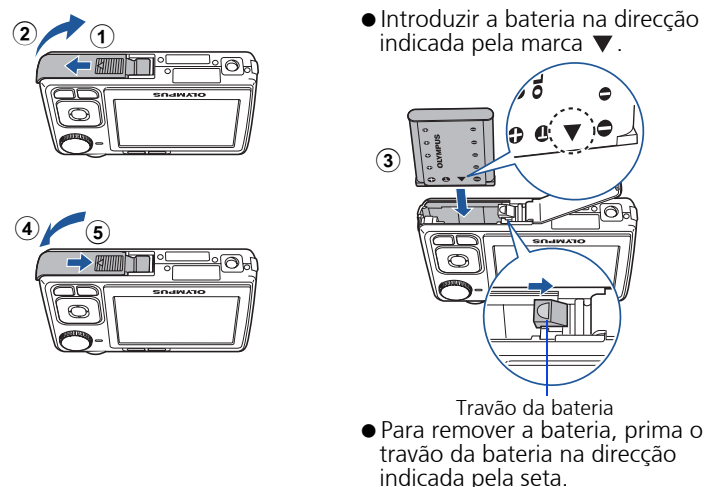

• Introduzir a bateria na direcção indicada pela marca ▼.

Travão da bateria
• Para remover a bateria, prima o travão da bateria na direcção indicada pela seta.

3 Ligar a câmara

Este modo explica como ligar a câmara no modo fotografia.
a. Colocar o selector de modo em AUTO.

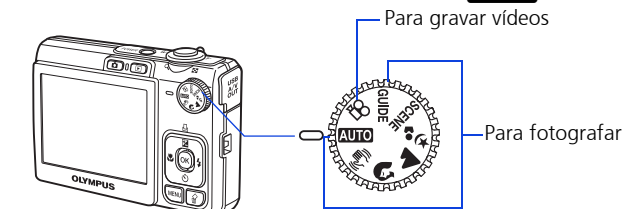

Modos de fotografia

- AUTO** Para uma fotografia normal.
Esta função reduz o efeito de arrastamento resultante de um tema fotográfico em movimento ou da própria oscilação da câmara ao fotografar.
- SCENE** Seleccione de entre os 10 (FE-240/X-795) ou 13 (FE-230/X-790) modos de cena disponíveis, de acordo com as condições fotográficas.
- GUIDE** Usar o assistente de fotografia, visualizado no ecrã, para fotografar imagens mediante a situação.

b. Premir o botão POWER.

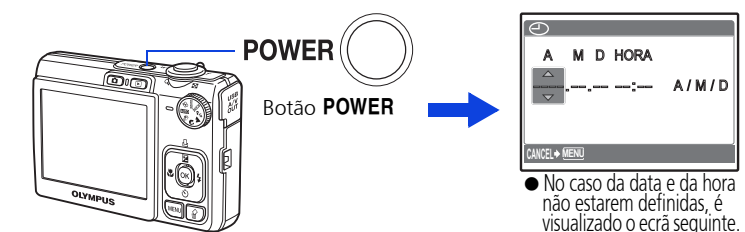

• Para desligar a câmara, premir novamente o botão POWER.

Sugestão

As direcções do selector em cruz são indicadas com ▲▼◀▶ no manual de instruções fornecido.

4 Definir a data e hora

Sobre o ecrã de definição da data e hora

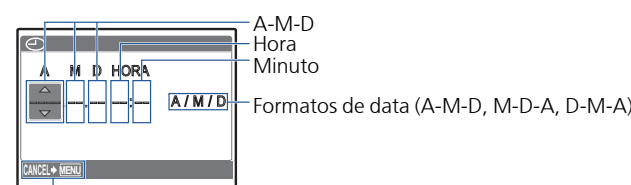

a. Premir os botões ▲/▼ e ◀/▶ de modo a seleccionar [A].

• Os primeiros dois dígitos do ano são fixos.

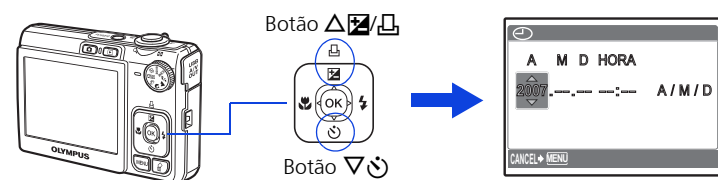

b. Premir o botão ▶/⚡.

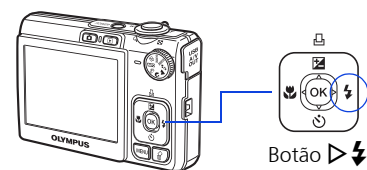

c. Premir os botões ▲/▼ e ◀/▶ para seleccionar [M].

d. Premir o botão ▶/⚡.

e. Premir os botões ▲/▼ e ◀/▶ de modo a seleccionar [D].

f. Premir o botão ▶/⚡.

g. Premir os botões ▲/▼ e ◀/▶ para seleccionar as horas e minutos.

• A hora é visualizada no formato de 24 horas.

h. Premir o botão ▶/⚡.

i. Premir os botões ▲/▼ e ◀/▶ para seleccionar [A/M/D].

j. Depois de configuradas todas as definições, premir (OK).

• Para uma definição mais precisa, premir (OK) quando o sinal de hora chegar aos 00 segundos.

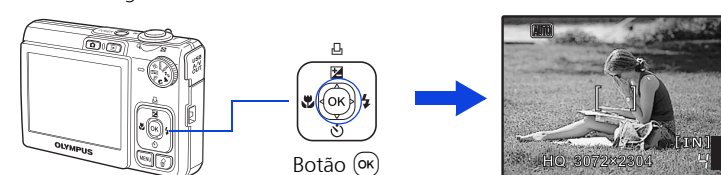

5 Fotografar

a. Segurar a câmara.

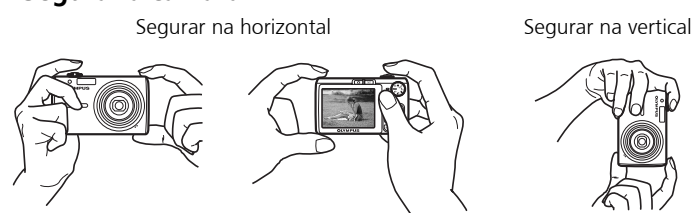

b. Focagem.

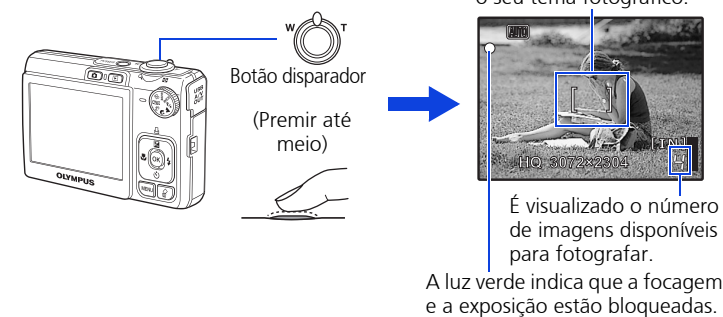

c. Fotografar.

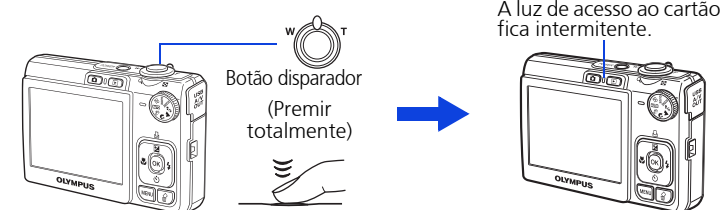

6 Ver as suas imagens

a. Premir o botão ▶.

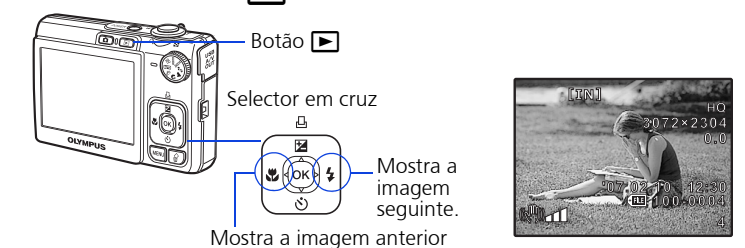

Apagar imagens

a. Premir os botões ◀/▶ e ▶/⚡ de modo a visualizar a imagem que pretende apagar.

b. Premir o botão (OK).

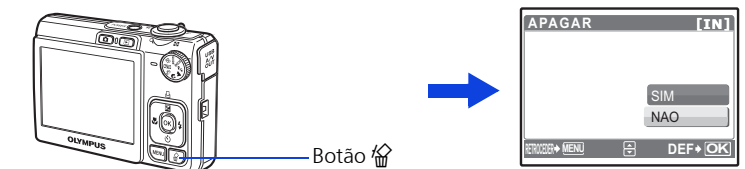

c. Premir o botão ▲/▼, para seleccionar [SIM], e premir (OK).

